

GILLETT

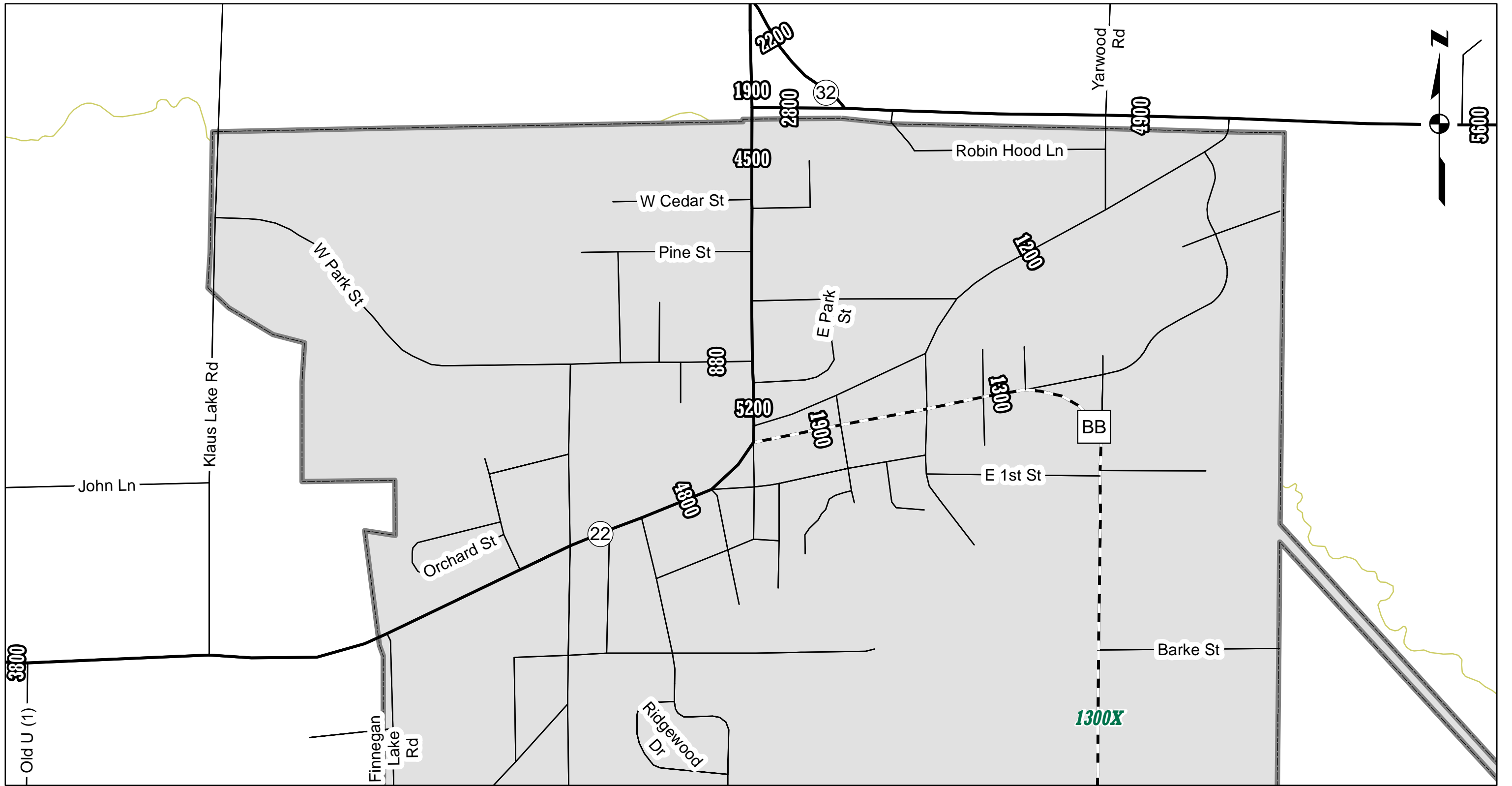

USH 141 DETAIL

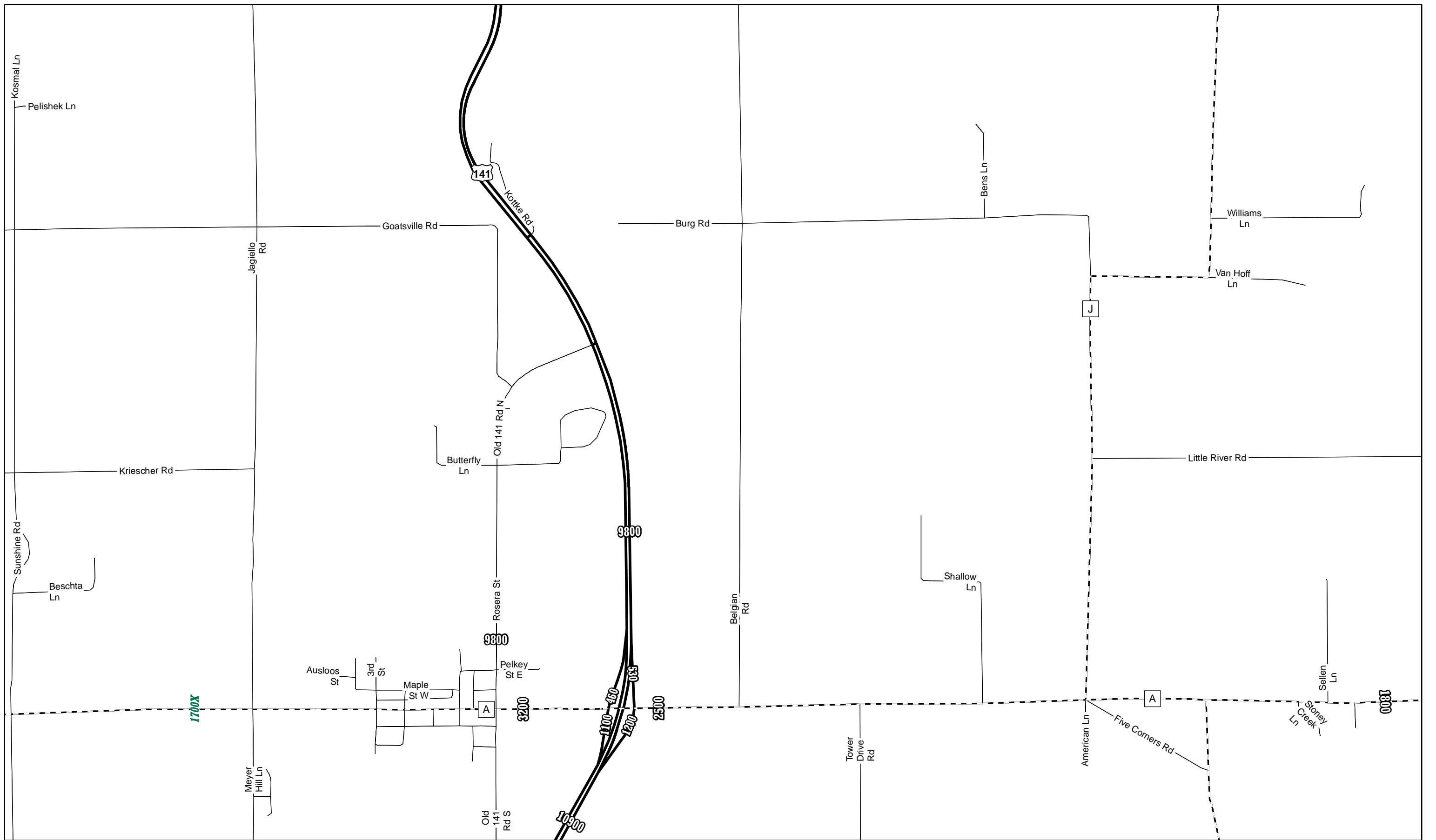

9999 = 2009

- 9999# = 2008
- 9999* = 2007
- 9999@ = 2006
- 9999^ = 2005
- 9999~ = 2004
- 9999x = 2003 or older

- Character following count value designates the year the count was taken
- Ramp counts lie parallel to road
- AADT for Roads lie perpendicular to road

Legend

- IH
- USH
- STH
- - - CTH
- Local Roads
- Railroads

2009
INSETS
OCONTO County